

INTERIOR DESIGN®

DECEMBER
2013

bestofyear

A photograph of a man walking away from the camera down a central aisle of a theater. The theater's walls are covered in large, dark brown acoustic panels in the upper section and bright green acoustic panels in the lower section. Several small, dark rectangular speakers are mounted on the green wall. The seats are upholstered in a patterned fabric, and the floor is dark wood. The overall atmosphere is modern and architectural.

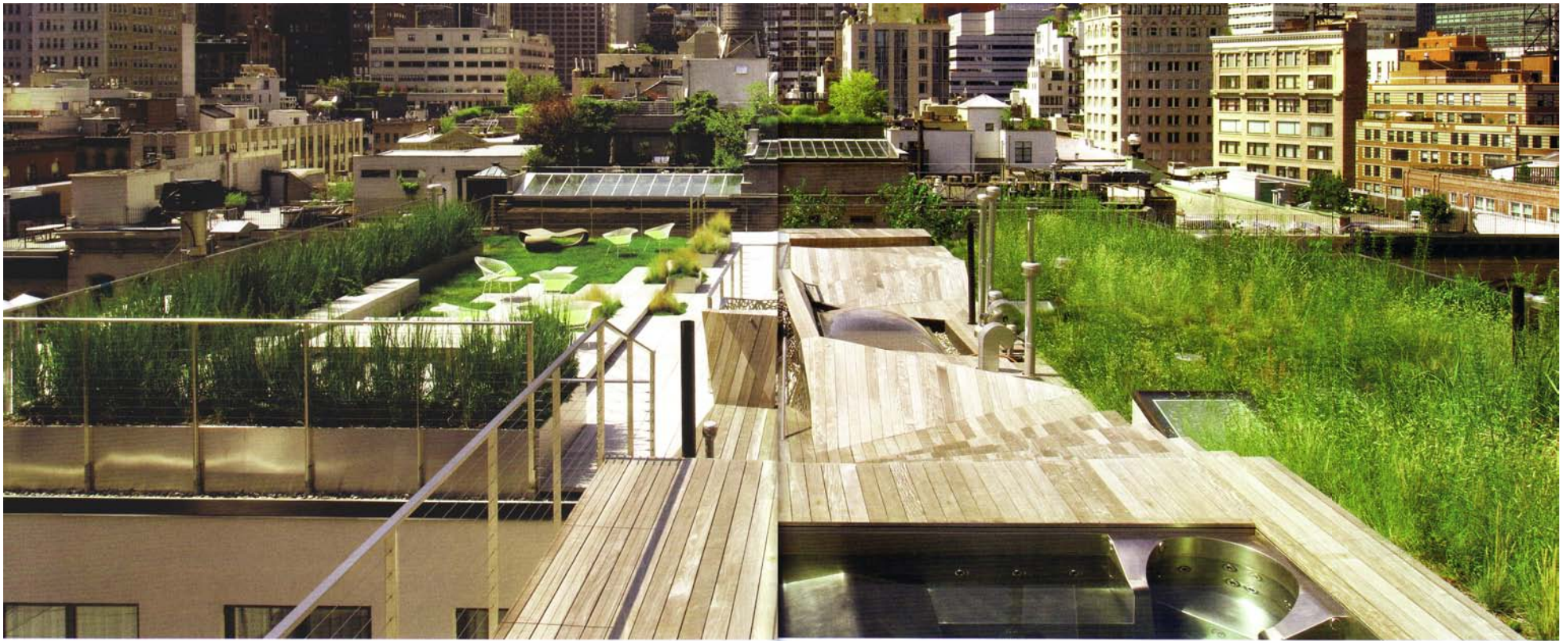

best of year
LARGE APARTMENT



NEW YORK

**STEVE E. BLATZ ARCHITECT
AND ANTONIO PIO SARACINO**

The manicured lawn, the hot tub, the indoor-outdoor kitchen. Steve E. Blatz and Antonio Pio Saracino's biggest residential project ever has all the trappings typical of Los Angeles. The difference? This residence is a Manhattan rarity: Blatz and Saracino spent four years creating an urban oasis with more square footage outdoors (7,000) than in (5,000). Vintage, contemporary, and custom furnishings share a streamlined masculine sensibility. Rodolfo Dordoni sofas flank a cocktail table with a jigsaw-puzzle top in the living area, which sacrificed some of its space to make way for a glassed-in courtyard. Said courtyard contains the main access to the roof terrace: a spiral staircase concealed inside a cocoon of laser-cut mirror-polished stainless steel. Up on the roof, Blatz, Saracino, and landscaping consultant HMWhite transformed barren tar and unsightly mechanical equipment into a glorious haven where chaise longuees by Richard Schultz are ideal for admiring the Woolworth Building and 1 World Trade Center. —*Manica Khemsurav* ➤

MICHAEL SMITH; NINA ETRNER; FILIPPO FERRARIS; JOEL AGUSTIN; MACIEJ RATKOWSKI; BRIAN LAU; STEVE E. BLATZ ARCHITECT.